

Cloud Q Remedy Kit

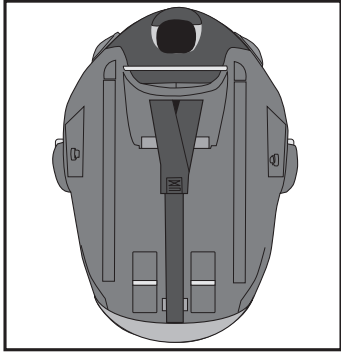

1. Turn seat over to access harness adjuster strap and splitter plate.

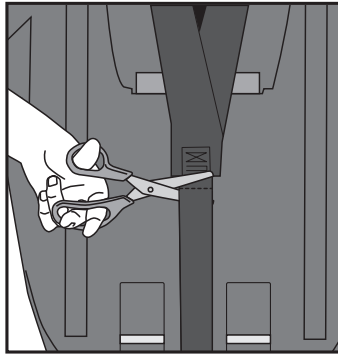

2. Cut adjuster strap just below sewn plate as shown. Cut in a straight line, and only cut once. Do not pull adjuster strap out of slot.

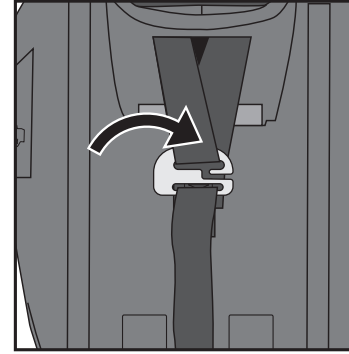

3. Attach new adjuster strap and metal splitter plate to harness above the sewn splitter.

1. Turn seat over to access harness adjuster strap and splitter plate.

2. Cut adjuster strap just below sewn plate as shown. Cut in a straight line, and only cut once. Do not pull adjuster strap out of slot.

3. Attach new adjuster strap and metal splitter plate to harness above the sewn splitter.

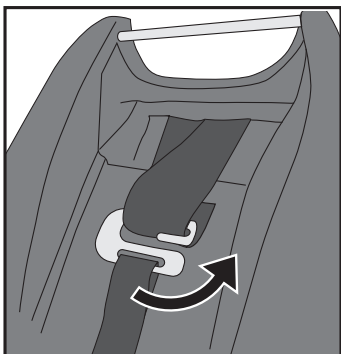

4. Fold harness behind splitter plate.

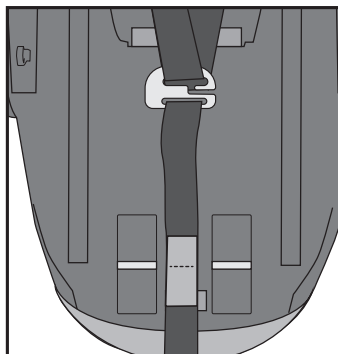

5. Tape new adjuster strap to original adjuster strap with supplied tape as shown. Press tape firmly in place.

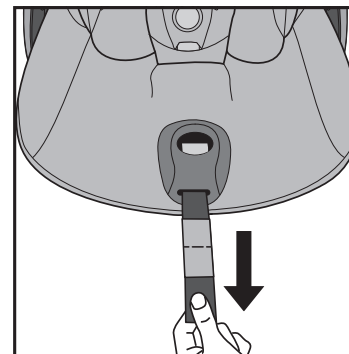

6. Pull adjuster strap through the harness adjuster slot. Pull until original strap is out and new strap is through the slot.

4. Fold harness behind splitter plate.

5. Tape new adjuster strap to original adjuster strap with supplied tape as shown. Press tape firmly in place.

6. Pull adjuster strap through the harness adjuster slot. Pull until original strap is out and new strap is through the slot.

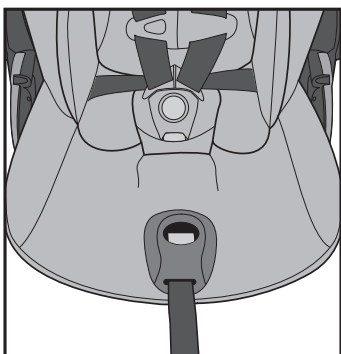

7. Remove original strap and tape, and discard.

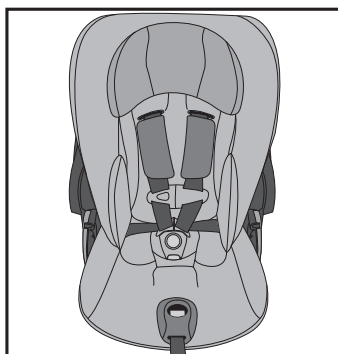

8. Seat is now ready to use.

Instructional Videos



<https://cybex-online.com/en-us/safety-notice-and-recalls/sirona-m>

Cybex Customer Care:
1-877-242-5676

7. Remove original strap and tape, and discard.

8. Seat is now ready to use.